

**Nokia Customer Care
6255/6255i/6256/6256i (RM-19)
Mobile Terminal**

Parts Lists and Exploded View

Contents	Page
Exploded View	3
Assembly Parts List	4
Parts List – Build 011– Engine Code 0202264.....	6

Exploded View

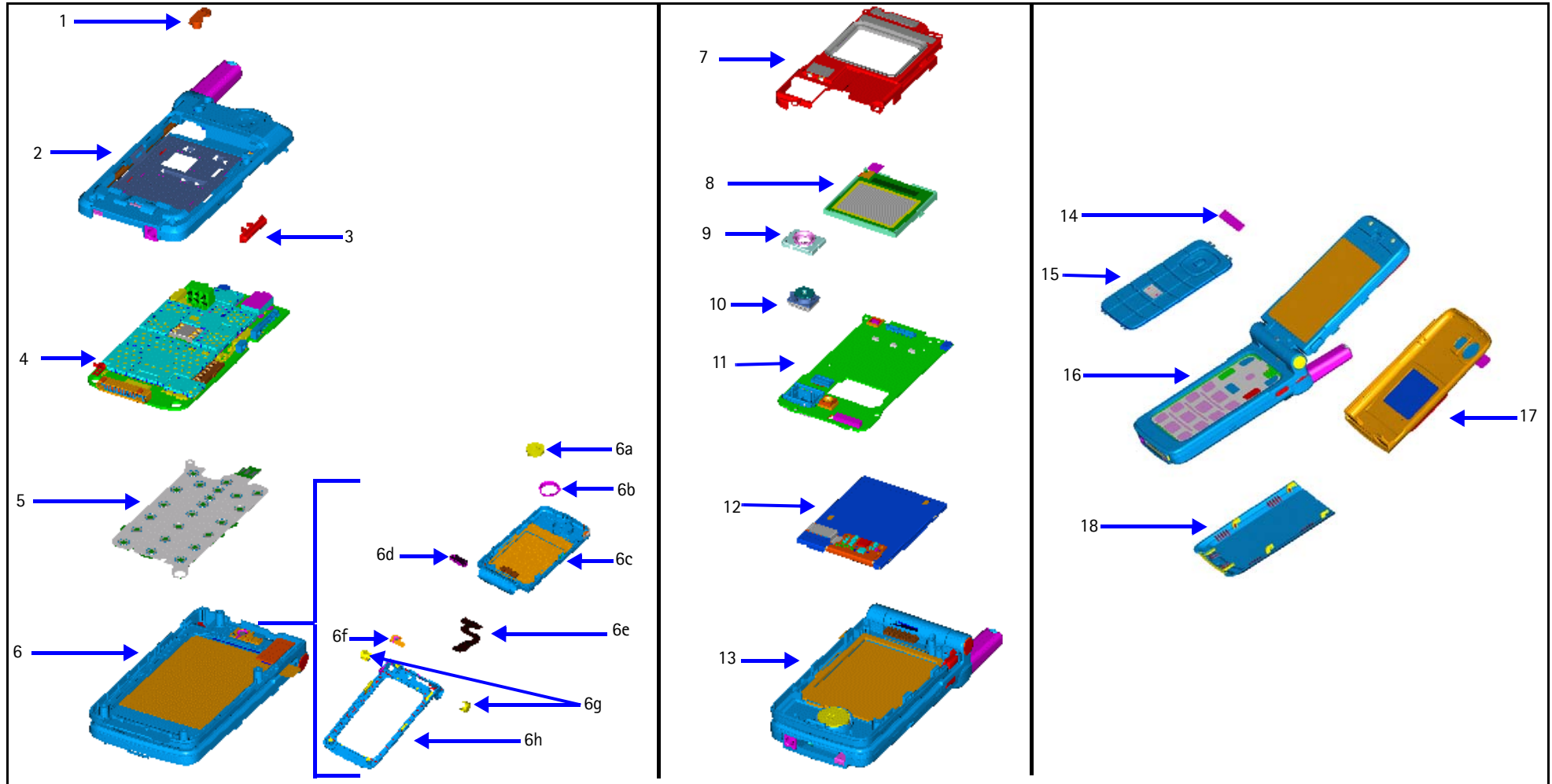

Assembly Parts List

Item	Qty	Description	NMP Code
1	1	Headset jack plug	5469271
*	4	Screws	6380145
2	1	D-cover/IHF assembly	0266126
3	1	Volume key	5201001
4	1	Main engine PWB	0202264
5	1	Dome sheet assembly	9795212
6	1	B/C-cover assembly	0266114
6a	1	Speaker	5140067
6b	1	Earpiece gasket	9470703
6c	1	B-cover assembly	9492004
6d	1	Hinge	9590241
6e	1	Hinge flex cable	9855112
6f	1	Adhesive flip detection	9400320
6g	2	Hinge caps	9900053
6h	1	C-cover	9454015
*	4	Screws	6380145
7	1	Inner housing	9517425
8	1	Main display module	4850807
9	1	Upper camera shield	9560316
10	1	VGA camera module	4858023
11	1	UI PWB: Version A (6255i/6256i) Version B (6255/6256)	0210118 0202441
12	1	Secondary display module	4850825
13	1	Lower fold assembly	N/A
14	1	Co-label	(Carrier dependent)
*	1	Screw	6380223

Item	Qty	Description	NMP Code
15	1	Keymat assembly: <u>Latin</u> Blue Red Black Dark Grey <u>Chinese</u> Blue Red Black <u>Thai</u> Blue Black	 9791448 9791435 9797207 9791449 9791450 9791434 9797208 9797387 9797385
16	1	B, C, and D-cover assembly	N/A
17	1	A-cover assembly: Blue Red Black Silver	 9491962 0266331 0266308 9491963
18	1	E-cover	9454017

* Not pictured in the exploded view.

Parts List – Build 011– Engine Code 0202264

Item	Code	Side	X	Y	Description
A8000	9517418	Bottom	C	6	DUPLEXER SHIELD ASSY DNS08913
A8001	9517420	Bottom	G	5	RX SHIELD ASSY DNS08915 HDDA3
A8002	9517419	Bottom	H	8	TX SHIELD ASSY DNS08914 HDDA3
A8003	9517416	Bottom	M	6	BASEBAND SHIELD ASSY DNS08908
A8004	9517417	Bottom	O	2	BLUETOOTH SHIELD ASSY DNS08909
B2200	4510405	Bottom	M	3	CRYSTAL 32.768KHZ+-20PPM 12.5PF
C2000	2351009	Top	R	3	CHIPCAP X5R 1U K 6V3 0402
C2001	2351009	Top	Q	3	CHIPCAP X5R 1U K 6V3 0402
C2002	2320620	Top	Q	4	CHIPCAP X7R 10N J 16V 0402
C2004	2320805	Top	Q	5	CHIPCAP X5R 100N K 10V 0402
C2008	2320536	Top	Q	7	CHIPCAP NP0 10P J 50V 0402
C2009	2320536	Top	Q	6	CHIPCAP NP0 10P J 50V 0402
C2010	2320536	Top	Q	7	CHIPCAP NP0 10P J 50V 0402
C2011	2320536	Top	Q	7	CHIPCAP NP0 10P J 50V 0402
C2012	2320744	Bottom	P	3	CHIPCAP X7R 1N0 K 50V 0402
C2013	2320544	Bottom	P	2	CHIPCAP NP0 22P J 50V 0402
C2014	2320552	Bottom	D	8	CHIPCAP NP0 47P J 50V 0402
C2015	2320552	Bottom	D	8	CHIPCAP NP0 47P J 50V 0402
C2016	2351009	Bottom	E	8	CHIPCAP X5R 1U K 6V3 0402
C2017	2320596	Top	R	8	CHIPCAP X7R 3N3 J 50V 0402
C2018	2320596	Top	R	7	CHIPCAP X7R 3N3 J 50V 0402
C2019	2320596	Top	Q	6	CHIPCAP X7R 3N3 J 50V 0402
C2020	2320596	Top	R	7	CHIPCAP X7R 3N3 J 50V 0402
C2021	2320596	Top	Q	6	CHIPCAP X7R 3N3 J 50V 0402
C2022	2320596	Top	Q	6	CHIPCAP X7R 3N3 J 50V 0402
C2100	2320805	Top	R	8	CHIPCAP X5R 100N K 10V 0402
C2101	2320805	Top	R	8	CHIPCAP X5R 100N K 10V 0402
C2102	2320805	Top	R	6	CHIPCAP X5R 100N K 10V 0402
C2103	2320805	Top	C	3	CHIPCAP X5R 100N K 10V 0402
C2104	2320552	Top	B	3	CHIPCAP NP0 47P J 50V 0402
C2105	2320552	Top	B	3	CHIPCAP NP0 47P J 50V 0402

Item	Code	Side	X	Y	Description
C2106	2320805	Top	C	3	CHIPCAP X5R 100N K 10V 0402
C2107	2320805	Top	B	3	CHIPCAP X5R 100N K 10V 0402
C2108	2320505	Top	B	3	CHIPCAP X5R 4U7 K 6.3V 0603
C2109	2320548	Top	Q	6	CHIPCAP NP0 33P J 50V 0402
C2110	2320505	Top	B	3	CHIPCAP X5R 4U7 K 6.3V 0603
C2111	2320805	Bottom	N	4	CHIPCAP X5R 100N K 10V 0402
C2112	2320805	Top	B	2	CHIPCAP X5R 100N K 10V 0402
C2113	2320805	Top	Q	8	CHIPCAP X5R 100N K 10V 0402
C2114	2320805	Top	Q	8	CHIPCAP X5R 100N K 10V 0402
C2115	2320805	Top	Q	8	CHIPCAP X5R 100N K 10V 0402
C2116	2320805	Top	C	3	CHIPCAP X5R 100N K 10V 0402
C2117	2320566	Top	Q	3	CHIPCAP X7R 180P J 50V 0402
C2118	2320620	Top	Q	3	CHIPCAP X7R 10N J 16V 0402
C2119	2351009	Top	Q	3	CHIPCAP X5R 1U K 6V3 0402
C2120	2351009	Top	Q	3	CHIPCAP X5R 1U K 6V3 0402
C2200	2310037	Bottom	J	2	CHIPCAP X5R 10U M 6V3 0805
C2201	2320778	Bottom	K	3	CHIPCAP X7R 10N K 16V 0402
C2202	2315269	Bottom	M	3	CHIP ARRAY X5R 2X1U (2x1U2) K 6V3 0405
C2203	2315269	Bottom	M	5	CHIP ARRAY X5R 2X1U (2x1U2) K 6V3 0405
C2204	2315269	Bottom	M	4	CHIP ARRAY X5R 2X1U (2x1U2) K 6V3 0405
C2205	2351009	Bottom	K	3	CHIPCAP X5R 1U K 6V3 0402
C2209	2315269	Bottom	M	3	CHIP ARRAY X5R 2X1U (2x1U2) K 6V3 0405
C2210	2315269	Bottom	M	4	CHIP ARRAY X5R 2X1U (2x1U2) K 6V3 0405
C2211	2320778	Bottom	N	4	CHIPCAP X7R 10N K 16V 0402
C2214	2315269	Bottom	N	4	CHIP ARRAY X5R 2X1U (2x1U2) K 6V3 0405
C2215	2320805	Bottom	M	5	CHIPCAP X5R 100N K 10V 0402
C2216	2320805	Bottom	J	5	CHIPCAP X5R 100N K 10V 0402
C2217	2320805	Bottom	J	4	CHIPCAP X5R 100N K 10V 0402
C2218	2320805	Bottom	J	4	CHIPCAP X5R 100N K 10V 0402
C2224	2320778	Bottom	O	4	CHIPCAP X7R 10N K 16V 0402
C2226	2320778	Bottom	O	4	CHIPCAP X7R 10N K 16V 0402
C2227	2320778	Bottom	O	6	CHIPCAP X7R 10N K 16V 0402

Parts Lists and Exploded View

Item	Code	Side	X	Y	Description
C2228	2315269	Bottom	J	4	CHIP ARRAY X5R 2X1U (2x1U2) K 6V3 0405
C2229	2315269	Bottom	J	3	CHIP ARRAY X5R 2X1U (2x1U2) K 6V3 0405
C2230	2315269	Bottom	J	4	CHIP ARRAY X5R 2X1U (2x1U2) K 6V3 0405
C2233	2315269	Bottom	J	4	CHIP ARRAY X5R 2X1U (2x1U2) K 6V3 0405
C2270	2320143	Bottom	K	3	CHIPCAP X5R 220N K 6.3V 0402
C2272	2315269	Bottom	J	3	CHIP ARRAY X5R 2X1U (2x1U2) K 6V3 0405
C2273	2315269	Bottom	J	4	CHIP ARRAY X5R 2X1U (2x1U2) K 6V3 0405
C2274	2315269	Bottom	J	3	CHIP ARRAY X5R 2X1U (2x1U2) K 6V3 0405
C2277	2315269	Bottom	J	3	CHIP ARRAY X5R 2X1U (2x1U2) K 6V3 0405
C2300	2320505	Bottom	N	9	CHIPCAP X5R 4U7 K 6.3V 0603
C2301	2320505	Bottom	N	9	CHIPCAP X5R 4U7 K 6.3V 0603
C2302	2320805	Bottom	L	9	CHIPCAP X5R 100N K 10V 0402
C2303	2320505	Bottom	M	9	CHIPCAP X5R 4U7 K 6.3V 0603
C2304	2320505	Bottom	M	9	CHIPCAP X5R 4U7 K 6.3V 0603
C2400	2320552	Bottom	B	6	CHIPCAP NP0 47P J 50V 0402
C2401	2320536	Bottom	B	6	CHIPCAP NP0 10P J 50V 0402
C2402	1825133	Bottom	B	6	CHIP VARISTOR VWM14V VC50V 0402
C2403	1825133	Bottom	F	2	CHIP VARISTOR VWM14V VC50V 0402
C2404	1825133	Bottom	H	2	CHIP VARISTOR VWM14V VC50V 0402
C2405	2320481	Bottom	F	2	CHIPCAP X5R 1U K 6V3 0603
C2406	2320554	Bottom	F	2	CHIPCAP NP0 56P J 50V 0402
C2407	2320764	Bottom	F	2	CHIPCAP X7R 6N8 K 25V 0402
C2408	2320805	Bottom	I	2	CHIPCAP X5R 100N K 10V 0402
C2409	2320552	Bottom	B	5	CHIPCAP NP0 47P J 50V 0402
C2450	2320552	Bottom	C	1	CHIPCAP NP0 47P J 50V 0402
C2600	2320805	Bottom	E	9	CHIPCAP X5R 100N K 10V 0402
C2601	2320805	Bottom	E	9	CHIPCAP X5R 100N K 10V 0402
C2602	2320505	Bottom	E	9	CHIPCAP X5R 4U7 K 6.3V 0603
C2700	2320805	Bottom	J	7	CHIPCAP X5R 100N K 10V 0402
C2800	2320778	Bottom	O	6	CHIPCAP X7R 10N K 16V 0402
C2801	2320778	Bottom	J	6	CHIPCAP X7R 10N K 16V 0402
C2802	2320778	Bottom	M	7	CHIPCAP X7R 10N K 16V 0402

Item	Code	Side	X	Y	Description
C2803	2320778	Bottom	J	5	CHIPCAP X7R 10N K 16V 0402
C2804	2320778	Bottom	J	5	CHIPCAP X7R 10N K 16V 0402
C2805	2320778	Bottom	J	7	CHIPCAP X7R 10N K 16V 0402
C2806	2320778	Bottom	M	7	CHIPCAP X7R 10N K 16V 0402
C2807	2320778	Bottom	M	7	CHIPCAP X7R 10N K 16V 0402
C2808	2320778	Bottom	M	5	CHIPCAP X7R 10N K 16V 0402
C2809	2320778	Bottom	M	6	CHIPCAP X7R 10N K 16V 0402
C2810	2320778	Bottom	M	7	CHIPCAP X7R 10N K 16V 0402
C2811	2315269	Bottom	M	7	CHIP ARRAY X5R 2X1U (2x1U2) K 6V3 0405
C2900	2320778	Bottom	J	5	CHIPCAP X7R 10N K 16V 0402
C2901	2320778	Bottom	I	3	CHIPCAP X7R 10N K 16V 0402
C2902	2320620	Bottom	J	5	CHIPCAP X7R 10N J 16V 0402
C2903	2320744	Bottom	J	5	CHIPCAP X7R 1N0 K 50V 0402
C2904	2320783	Bottom	J	8	CHIPCAP X7R 33N K 10V 0402
C2905	2320620	Bottom	J	6	CHIPCAP X7R 10N J 16V 0402
C2906	2320744	Bottom	J	6	CHIPCAP X7R 1N0 K 50V 0402
C3000	2320778	Bottom	M	7	CHIPCAP X7R 10N K 16V 0402
C3001	2320805	Bottom	M	7	CHIPCAP X5R 100N K 10V 0402
C3002	2320778	Bottom	O	5	CHIPCAP X7R 10N K 16V 0402
C3003	2320805	Bottom	O	6	CHIPCAP X5R 100N K 10V 0402
C3004	2320778	Bottom	O	6	CHIPCAP X7R 10N K 16V 0402
C3200	2320481	Bottom	J	2	CHIPCAP X5R 1U K 6V3 0603
C3201	2320505	Bottom	J	2	CHIPCAP X5R 4U7 K 6.3V 0603
C3202	2320805	Bottom	J	2	CHIPCAP X5R 100N K 10V 0402
C6000	2320514	Bottom	O	2	CHIPCAP NP0 1P2 C 50V 0402
C6001	2320540	Bottom	P	2	CHIPCAP NP0 15P J 50V 0402
C6002	2320520	Bottom	N	3	CHIPCAP NP0 2P2 C 50V 0402
C6003	2320778	Bottom	N	2	CHIPCAP X7R 10N K 16V 0402
C6004	2320778	Bottom	N	3	CHIPCAP X7R 10N K 16V 0402
C6005	2320524	Bottom	O	2	CHIPCAP NP0 3P3 C 50V 0402
C6006	2316001	Bottom	N	3	CHIPCAP X5R 2U2 K 6V3 0603
C6007	2320778	Bottom	O	3	CHIPCAP X7R 10N K 16V 0402

Parts Lists and Exploded View

Item	Code	Side	X	Y	Description
C6008	2320778	Bottom	P	2	CHIPCAP X7R 10N K 16V 0402
C6009	2320540	Bottom	P	2	CHIPCAP NP0 15P J 50V 0402
C6010	2320778	Bottom	P	2	CHIPCAP X7R 10N K 16V 0402
C6011	2315269	Bottom	O	1	CHIP ARRAY X5R 2X1U (2x1U2) K 6V3 0405
C6100	2320785	Bottom	L	9	CHIPCAP X7R 47N K 10V 0402
C6101	2320778	Bottom	L	8	CHIPCAP X7R 10N K 16V 0402
C6102	2320778	Bottom	L	9	CHIPCAP X7R 10N K 16V 0402
C6103	2320805	Bottom	K	8	CHIPCAP X5R 100N K 10V 0402
C6104	2320560	Top	K	9	CHIPCAP NP0 100P J 50V 0402
C6105	2320744	Bottom	K	8	CHIPCAP X7R 1N0 K 50V 0402
C6106	2315209	Bottom	J	8	CHIP ARRAY X5R 2X33N M 10V 0405
C6107	2320744	Bottom	K	8	CHIPCAP X7R 1N0 K 50V 0402
C6108	2321007	Bottom	K	8	CHIPCAP X7R 22N K 16V 0402
C6109	2320546	Bottom	K	9	CHIPCAP NP0 27P J 50V 0402
C6110	2321007	Bottom	J	8	CHIPCAP X7R 22N K 16V 0402
C6111	2315261	Bottom	J	9	CHIP ARRAY X5R 2X47N K 10V 0405
C6112	2320785	Bottom	J	8	CHIPCAP X7R 47N K 10V 0402
C6113	2320752	Bottom	K	8	CHIPCAP X7R 2N2 K 50V 0402
C6114	2320760	Bottom	K	9	CHIPCAP X7R 4N7 K 25V 0402
C6115	2320552	Bottom	K	9	CHIPCAP NP0 47P J 50V 0402
C6116	2351009	Bottom	J	9	CHIPCAP X5R 1U K 6V3 0402
C6117	2320778	Bottom	J	9	CHIPCAP X7R 10N K 16V 0402
C6180	2320805	Bottom	N	4	CHIPCAP X5R 100N K 10V 0402
C6182	2320805	Bottom	O	4	CHIPCAP X5R 100N K 10V 0402
C7000	2320620	Bottom	H	9	CHIPCAP X7R 10N J 16V 0402
C7001	2320805	Bottom	H	7	CHIPCAP X5R 100N K 10V 0402
C7003	2320620	Bottom	I	9	CHIPCAP X7R 10N J 16V 0402
C7004	2320552	Bottom	H	9	CHIPCAP NP0 47P J 50V 0402
C7005	2320524	Bottom	H	9	CHIPCAP NP0 3P3 C 50V 0402
C7006	2320633	Bottom	H	9	CHIPCAP NP0 220P J 25V 0402
C7007	2320620	Bottom	H	7	CHIPCAP X7R 10N J 16V 0402
C7008	2320552	Bottom	H	8	CHIPCAP NP0 47P J 50V 0402

Item	Code	Side	X	Y	Description
C7009	2320536	Bottom	H	9	CHIPCAP NP0 10P J 50V 0402
C7010	2320536	Bottom	H	8	CHIPCAP NP0 10P J 50V 0402
C7011	2320508	Bottom	H	8	CHIPCAP NP0 1P0 C 50V 0402
C7012	2320532	Bottom	I	9	CHIPCAP NP0 6P8 C 50V 0402
C7014	2320604	Bottom	H	9	CHIPCAP NP0 18P J 50V 0402
C7015	2320620	Bottom	H	9	CHIPCAP X7R 10N J 16V 0402
C7016	2320508	Bottom	H	8	CHIPCAP NP0 1P0 C 50V 0402
C7017	2320560	Bottom	I	9	CHIPCAP NP0 100P J 50V 0402
C7018	2322023	Bottom	I	9	CHIPCAP NP0 2N2 J 16V 0603
C7019	2320560	Bottom	I	9	CHIPCAP NP0 100P J 50V 0402
C7020	2320554	Bottom	J	4	CHIPCAP NP0 56P J 50V 0402
C7021	2351009	Bottom	I	9	CHIPCAP X5R 1U K 6V3 0402
C7022	2320604	Bottom	I	8	CHIPCAP NP0 18P J 50V 0402
C7023	2320620	Bottom	I	8	CHIPCAP X7R 10N J 16V 0402
C7024	2320548	Bottom	I	8	CHIPCAP NP0 33P J 50V 0402
C7025	2320604	Bottom	I	8	CHIPCAP NP0 18P J 50V 0402
C7026	2320548	Bottom	H	8	CHIPCAP NP0 33P J 50V 0402
C7027	2320536	Bottom	I	8	CHIPCAP NP0 10P J 50V 0402
C7028	2320532	Bottom	I	8	CHIPCAP NP0 6P8 C 50V 0402
C7029	2320552	Bottom	G	9	CHIPCAP NP0 47P J 50V 0402
C7100	2320620	Bottom	I	5	CHIPCAP X7R 10N J 16V 0402
C7101	2360001	Bottom	I	5	CHIPCAP X5R 330N K 10V 0603
C7102	2320783	Bottom	I	5	CHIPCAP X7R 33N K 10V 0402
C7103	2320548	Bottom	H	5	CHIPCAP NP0 33P J 50V 0402
C7104	2320584	Bottom	H	5	CHIPCAP X7R 1N0 J 50V 0402
C7105	2320778	Bottom	I	3	CHIPCAP X7R 10N K 16V 0402
C7106	2320778	Bottom	I	4	CHIPCAP X7R 10N K 16V 0402
C7107	2320778	Bottom	I	3	CHIPCAP X7R 10N K 16V 0402
C7108	2320778	Bottom	H	4	CHIPCAP X7R 10N K 16V 0402
C7109	2320778	Bottom	H	4	CHIPCAP X7R 10N K 16V 0402
C7110	2320778	Bottom	I	3	CHIPCAP X7R 10N K 16V 0402
C7111	2320778	Bottom	I	4	CHIPCAP X7R 10N K 16V 0402

Parts Lists and Exploded View

Item	Code	Side	X	Y	Description
C7112	2320778	Bottom	H	4	CHIPCAP X7R 10N K 16V 0402
C7113	2320778	Bottom	H	4	CHIPCAP X7R 10N K 16V 0402
C7160	2320554	Bottom	D	4	CHIPCAP NP0 56P J 50V 0402
C7161	2320516	Bottom	D	5	CHIPCAP NP0 1P5 C 50V 0402
C7162	2320805	Bottom	D	3	CHIPCAP X5R 100N K 10V 0402
C7163	2320538	Bottom	D	3	CHIPCAP NP0 12P J 50V 0402
C7165	2320508	Bottom	E	3	CHIPCAP NP0 1P0 C 50V 0402
C7166	2320560	Bottom	E	5	CHIPCAP NP0 100P J 50V 0402
C7168	2320602	Bottom	E	5	CHIPCAP NP0 4P7 C 50V 0402
C7169	2320532	Bottom	G	4	CHIPCAP NP0 6P8 C 50V 0402
C7170	2320584	Bottom	F	4	CHIPCAP X7R 1N0 J 50V 0402
C7171	2320536	Bottom	G	4	CHIPCAP NP0 10P J 50V 0402
C7172	2320526	Bottom	F	5	CHIPCAP NP0 3P9 C 50V 0402
C7173	2320602	Bottom	F	4	CHIPCAP NP0 4P7 C 50V 0402
C7174	2320532	Bottom	G	4	CHIPCAP NP0 6P8 C 50V 0402
C7175	2320560	Bottom	F	3	CHIPCAP NP0 100P J 50V 0402
C7176	2320596	Bottom	F	3	CHIPCAP X7R 3N3 J 50V 0402
C7177	2320596	Bottom	F	3	CHIPCAP X7R 3N3 J 50V 0402
C7178	2320805	Bottom	F	4	CHIPCAP X5R 100N K 10V 0402
C7179	2320544	Bottom	F	3	CHIPCAP NP0 22P J 50V 0402
C7180	2320508	Bottom	F	3	CHIPCAP NP0 1P0 C 50V 0402
C7181	2320560	Bottom	F	3	CHIPCAP NP0 100P J 50V 0402
C7182	2320534	Bottom	I	3	CHIPCAP NP0 8P2 C 50V 0402
C7183	2320560	Bottom	F	4	CHIPCAP NP0 100P J 50V 0402
C7184	2320785	Bottom	E	4	CHIPCAP X7R 47N K 10V 0402
C7185	2320538	Bottom	E	3	CHIPCAP NP0 12P J 50V 0402
C7186	2320560	Bottom	F	3	CHIPCAP NP0 100P J 50V 0402
C7188	2320534	Bottom	H	3	CHIPCAP NP0 8P2 C 50V 0402
C7200	2351009	Bottom	G	5	CHIPCAP X5R 1U K 6V3 0402
C7202	2314001	Bottom	F	5	CHIPCAP NP0 470P J 6V3 0402
C7203	2320620	Bottom	G	5	CHIPCAP X7R 10N J 16V 0402
C7204	2314001	Bottom	F	5	CHIPCAP NP0 470P J 6V3 0402

Item	Code	Side	X	Y	Description
C7206	2314001	Bottom	F	5	CHIPCAP NP0 470P J 6V3 0402
C7207	2320584	Bottom	G	5	CHIPCAP X7R 1N0 J 50V 0402
C7209	2314001	Bottom	F	5	CHIPCAP NP0 470P J 6V3 0402
C7210	2314001	Bottom	F	5	CHIPCAP NP0 470P J 6V3 0402
C7211	2320576	Bottom	F	5	CHIPCAP X7R 470P J 50V 0402
C7212	2320620	Bottom	E	6	CHIPCAP X7R 10N J 16V 0402
C7213	2320805	Bottom	E	6	CHIPCAP X5R 100N K 10V 0402
C7214	2320552	Bottom	E	5	CHIPCAP NP0 47P J 50V 0402
C7215	2351009	Bottom	F	7	CHIPCAP X5R 1U K 6V3 0402
C7216	2320620	Bottom	F	7	CHIPCAP X7R 10N J 16V 0402
C7218	2320596	Bottom	E	6	CHIPCAP X7R 3N3 J 50V 0402
C7219	2320584	Bottom	F	6	CHIPCAP X7R 1N0 J 50V 0402
C7220	2320584	Bottom	F	6	CHIPCAP X7R 1N0 J 50V 0402
C7221	2320783	Bottom	F	6	CHIPCAP X7R 33N K 10V 0402
C7222	2320764	Bottom	F	6	CHIPCAP X7R 6N8 K 25V 0402
C7223	2320518	Bottom	G	6	CHIPCAP NP0 1P8 C 50V 0402
C7224	2320805	Bottom	I	3	CHIPCAP X5R 100N K 10V 0402
C7225	2320620	Bottom	D	5	CHIPCAP X7R 10N J 16V 0402
C7226	2320805	Bottom	D	6	CHIPCAP X5R 100N K 10V 0402
C7300	2320536	Bottom	G	8	CHIPCAP NP0 10P J 50V 0402
C7301	2320536	Bottom	F	8	CHIPCAP NP0 10P J 50V 0402
C7303	2320943	Bottom	D	6	CHIPCAP NP0 HQ 1P0 B 16V 0402
C7304	2320501	Bottom	C	9	CHIPCAP NP0 1P2 B 50V 0402
C7305	2320584	Bottom	G	7	CHIPCAP X7R 1N0 J 50V 0402
C7306	2320620	Bottom	G	8	CHIPCAP X7R 10N J 16V 0402
C7307	2320540	Bottom	F	7	CHIPCAP NP0 15P J 50V 0402
C7308	2320530	Bottom	F	8	CHIPCAP NP0 5P6 C 50V 0402
C7309	2320536	Bottom	F	8	CHIPCAP NP0 10P J 50V 0402
C7311	2320620	Top	B	7	CHIPCAP X7R 10N J 16V 0402
C7312	2320560	Top	B	7	CHIPCAP NP0 100P J 50V 0402
C7313	2320596	Top	B	7	CHIPCAP X7R 3N3 J 50V 0402
C7314	2312255	Bottom	E	8	CHIPCAP X5R 10U K 10V 1206

Parts Lists and Exploded View

Item	Code	Side	X	Y	Description
C7315	2320560	Bottom	G	9	CHIPCAP NP0 100P J 50V 0402
C7316	2320532	Bottom	F	9	CHIPCAP NP0 6P8 C 50V 0402
C7317	2320943	Bottom	D	7	CHIPCAP NP0 HQ 1P0 B 16V 0402
C7318	2320584	Bottom	G	9	CHIPCAP X7R 1N0 J 50V 0402
C7319	2320560	Bottom	G	8	CHIPCAP NP0 100P J 50V 0402
C7320	2320584	Bottom	F	9	CHIPCAP X7R 1N0 J 50V 0402
C7321	2320584	Bottom	F	9	CHIPCAP X7R 1N0 J 50V 0402
C7322	2320532	Bottom	G	9	CHIPCAP NP0 6P8 C 50V 0402
C7323	2320524	Bottom	P	9	CHIPCAP NP0 3P3 C 50V 0402
C7325	2320552	Bottom	C	2	CHIPCAP NP0 47P J 50V 0402
C7326	2320552	Bottom	C	2	CHIPCAP NP0 47P J 50V 0402
C7327	2320552	Bottom	E	1	CHIPCAP NP0 47P J 50V 0402
C7328	2320552	Bottom	D	1	CHIPCAP NP0 47P J 50V 0402
C7329	2320544	Bottom	C	2	CHIPCAP NP0 22P J 50V 0402
C7330	2320544	Bottom	C	2	CHIPCAP NP0 22P J 50V 0402
C7399	2320532	Bottom	G	7	CHIPCAP NP0 6P8 C 50V 0402
D2200	4376371	Bottom	L	4	UEMEK2v0 LF WDENA TFBGA244
D2800	4375107	Bottom	K	6	TIKUEDGE1.1 F751728A C035 288UBGA
D3000	4347215	Bottom	M	8	SDRAM 4MX16 1.8V/1.8V WBGA60 PBFREE
D3001	4347041	Bottom	N	5	FLASH 8MX16 1.8/1.8V FBGA44
D3002	4347157	Bottom	N	8	COMBO ADAPTER + 64M NAND TBGA44 PBFREE
D6000	4349855	Bottom	N	2	SINGLE INV 74LX1G04
F2000	5119039	Bottom	P	4	SM FUSE F 2.0A 32V 0603
G7200	4520005	Bottom	G	5	VCTCXO 19.2MHZ 2.78V
G7201	4520013	Bottom	G	6	UHF VCO 986-1034MHz/2040-2140MHz
L2000	3203755	Top	Q	5	FERRITE BEAD 0.6R 600R/100MZ 0402
L2001	3203755	Top	R	5	FERRITE BEAD 0.6R 600R/100MZ 0402
L2002	3203755	Top	Q	5	FERRITE BEAD 0.6R 600R/100MZ 0402
L2003	3203803	Top	Q	6	CHIP BEAD ARRAY 2X1000R OR75 0405
L2004	3203803	Top	Q	7	CHIP BEAD ARRAY 2X1000R OR75 0405
L2005	3203803	Top	Q	7	CHIP BEAD ARRAY 2X1000R OR75 0405
L2006	3203743	Bottom	P	3	FERR.BEAD OR03 42R/100MHZ 3A 0805

Item	Code	Side	X	Y	Description
L2100	3203803	Top	Q	6	CHIP BEAD ARRAY 2X1000R 0R75 0405
L2151	3203807	Bottom	C	4	CHIP BEAD ARRAY 2X220R 0405
L2300	3203723	Bottom	M	9	FERRITE BEAD 0R35 68R/100MHZ 0603
L2301	3648941	Bottom	N	9	CHOKER 6.8UH M 1A 0R31 3.6X3.6X1.2
L2400	3648955	Bottom	H	2	COIL 0.47MH 50MA 3.3X3.4X1.4MM
L6000	3646051	Bottom	O	2	CHIP COIL 3N9 +-0N3 Q28/800M 0402
L6001	3646051	Bottom	O	2	CHIP COIL 3N9 +-0N3 Q28/800M 0402
L6003	3646063	Bottom	O	2	CHIP COIL 22N J Q28/800MHZ 0402
L6004	3646063	Bottom	O	2	CHIP COIL 22N J Q28/800MHZ 0402
L6100	3648975	Bottom	L	8	CHIP COIL 33N G Q20/500MHZ 0402
L6101	3648975	Bottom	L	8	CHIP COIL 33N G Q20/500MHZ 0402
L6102	3646081	Top	K	9	CHIP COIL 68N J Q17/300MHZ 0402
L6103	3646139	Bottom	K	9	CHIP COIL 120NH J Q8/100MHZ 0402
L7000	3646235	Bottom	G	8	CHIP COIL 15N J Q7/100MHZ 0402
L7001	3646235	Bottom	G	8	CHIP COIL 15N J Q7/100MHZ 0402
L7002	3646217	Bottom	H	8	CHIP COIL 3N9 +-0N3 Q7/100M 0402
L7003	3646217	Bottom	H	8	CHIP COIL 3N9 +-0N3 Q7/100M 0402
L7101	3645009	Bottom	H	5	CHIP COIL 33NH J Q12/100MHZ 0603
L7160	3646061	Bottom	D	4	CHIP COIL 15N J Q30/800MHZ 0402
L7161	3646099	Bottom	D	3	CHIP COIL 2N7 +-0N3 Q29/800M 0402
L7162	3646405	Bottom	D	4	CHIP COIL 6N2 J Q20/250MHZ 0402
L7163	3646415	Bottom	D	4	CHIP COIL 19N J Q24/250MHZ 0402
L7164	3645351	Bottom	E	5	CHIP COIL 220N J Q8/50MHZ 0603
L7165	3645095	Bottom	G	4	CHIP COIL 120N J Q16/100MHZ 0603
L7166	3646065	Bottom	E	3	CHIP COIL 12N J Q31/800MHZ 0402
L7167	3645301	Bottom	F	4	CHIP COIL 180N J Q13/100MHZ 0603
L7168	3645351	Bottom	G	4	CHIP COIL 220N J Q8/50MHZ 0603
L7169	3645095	Bottom	G	5	CHIP COIL 120N J Q16/100MHZ 0603
L7170	3646135	Bottom	F	4	CHIP COIL 82N +-0N3 Q17/300M 0402
L7171	3646067	Bottom	E	3	CHIP COIL 18N J Q29/800MHZ 0402
L7172	3646047	Bottom	G	6	CHIP COIL 3N3 +-0N3 Q28/800M 0402
L7173	3646135	Bottom	E	4	CHIP COIL 82N +-0N3 Q17/300M 0402

Parts Lists and Exploded View

Item	Code	Side	X	Y	Description
L7174	3645161	Bottom	F	4	CHIP COIL 150N J Q14/100MHZ 0603
L7175	3646061	Bottom	E	4	CHIP COIL 15N J Q30/800MHZ 0402
L7176	3645095	Bottom	I	3	CHIP COIL 120N J Q16/100MHZ 0603
L7177	3645095	Bottom	H	3	CHIP COIL 120N J Q16/100MHZ 0603
L7178	3645351	Bottom	G	5	CHIP COIL 220N J Q8/50MHZ 0603
L7179	3645195	Bottom	H	3	CHIP COIL 82N J Q12/100MHZ 0603
L7200	3646047	Bottom	G	7	CHIP COIL 3N3 +-0N3 Q28/800M 0402
L7301	3646081	Bottom	C	8	CHIP COIL 68N J Q17/300MHZ 0402
L7302	4550283	Bottom	C	8	DIR.COUPLER 824-849MHZ 1.6X0.8MM
L7303	3646009	Top	C	7	CHIP COIL 10N J Q30/800MHZ 0402
L7305	3646051	Bottom	D	7	CHIP COIL 3N9 +-0N3 Q28/800M 0402
L7307	4550287	Bottom	B	8	DIR.COUPLER 1850-1910MHZ 1.6X0.8
L7308	3646421	Bottom	D	6	CHIP COIL 1N0 K Q16/250MHZ 0402
L7309	3646047	Bottom	F	8	CHIP COIL 3N3 +-0N3 Q28/800M 0402
L7310	3646417	Bottom	C	9	CHIP COIL 5N6 J Q20/250MHZ 0402
L7311	3648967	Bottom	C	9	CHIP COIL 27N C Q25/250MHz 0402
L7312	3646107	Bottom	P	9	CHIP COIL 1N5 +-0N1 Q45/1GHZ 0402
N2000	4370961	Top	Q	4	NUT/CP2137 ASIC HBCC16++
N2002	4341705	Bottom	E	9	CURRNT SENS LM3820 USMD10 PB-FREE
N2100	4342429	Top	Q	3	AF AMP 0.4W LM4890/NCP2890 PBFREE
N2301	4341635	Bottom	N	9	DC/DC BUCK REG(NCP1510)USMD9
N2400	4346027	Bottom	G	2	EL DRIVER D381A 2-7V MSOP-10
N2600	4865403	Bottom	E	9	IRDA 1.15Mbps 2.2mm RoHS
N3200	4341561	Bottom	I	2	VREG 2.85/150MA(LP3987-2.85)USMD5
N6000	4376355	Bottom	O	3	TJA4 BLUETOOTH DEVICE
N6001	4341561	Bottom	N	1	VREG 2.85/150MA(LP3987-2.85)USMD5
N6100	4341427	Bottom	K	9	FM RECEIVER(TEA5767HN) LQFP40
N7000	4380021	Bottom	I	8	JUPITER D4 PMB3365G VQFN-40
N7100	4380033	Bottom	I	4	BATMAN RF RX ASIC STB7102FTR
N7160	4375161	Bottom	E	4	LNA/MIXER/DOWNCNTR ALFRED VQFN-24
N7200	4341395	Bottom	E	5	1XPLL/SYNTH 2.5GHZ(LMX2310U)MLF20
N7300	4129091	Top	B	7	ASIP STPAC01F2 CDMA PWR DET BGA-8

Item	Code	Side	X	Y	Description
N7301	4355671	Bottom	F	9	PW AMP SKY77402 CDMA800 CENTAURUS
N7302	4355655	Bottom	F	8	PW AMP RF3448 CDMA1900
R2000	1430115	Bottom	E	8	CHIPRES 0W06 2K2 F 200PPM 0402
R2001	1430115	Bottom	D	8	CHIPRES 0W06 2K2 F 200PPM 0402
R2002	1820039	Bottom	I	2	NTC RES 0W1 47K J B 4050+-3% 0402
R2006	1825033	Top	Q	4	CHIP VARISTOR VWM14V VC46V 0402
R2007	1430714	Top	Q	4	CHIPRES 0W06 33R J 0402
R2008	1430804	Top	Q	5	CHIPRES 0W06 100K J 0402
R2009	4129265	Top	Q	4	ASIP USB2 FILTER BGA10 PBFREE
R2010	1430812	Top	Q	4	CHIPRES 0W06 220K J 0402
R2011	1430812	Top	R	3	CHIPRES 0W06 220K J 0402
R2012	1825033	Top	R	8	CHIP VARISTOR VWM14V VC46V 0402
R2013	1825033	Top	R	7	CHIP VARISTOR VWM14V VC46V 0402
R2014	1825033	Top	Q	7	CHIP VARISTOR VWM14V VC46V 0402
R2015	1825033	Top	R	7	CHIP VARISTOR VWM14V VC46V 0402
R2050	1430812	Bottom	L	3	CHIPRES 0W06 220K J 0402
R2100	1430804	Top	C	3	CHIPRES 0W06 100K J 0402
R2101	1430754	Top	B	3	CHIPRES 0W06 1K0 J 0402
R2102	1430700	Top	B	3	CHIPRES 0W06 10R J 0402
R2103	1430742	Top	B	3	CHIPRES 0W06 390R J 0402
R2104	1825033	Bottom	D	4	CHIP VARISTOR VWM14V VC46V 0402
R2105	1430693	Top	R	7	CHIPRES 0W06 5R6 J 0402
R2106	1430693	Top	Q	7	CHIPRES 0W06 5R6 J 0402
R2107	1430693	Top	R	6	CHIPRES 0W06 5R6 J 0402
R2108	1430693	Top	R	6	CHIPRES 0W06 5R6 J 0402
R2109	1430796	Top	B	2	CHIPRES 0W06 47K J 0402
R2110	1430804	Top	C	2	CHIPRES 0W06 100K J 0402
R2111	1430778	Top	B	2	CHIPRES 0W06 10K J 0402
R2112	1430804	Top	C	2	CHIPRES 0W06 100K J 0402
R2115	1430808	Top	Q	3	CHIPRES 0W06 150K J 0402
R2116	1430121	Top	Q	3	CHIPRES 0W06 22K F 200PPM 0402
R2117	1430137	Top	R	3	CHIPRES 0W06 1K0 F 200PPM 0402

Parts Lists and Exploded View

Item	Code	Side	X	Y	Description
R2118	1430137	Top	R	3	CHIPRES 0W06 1K0 F 200PPM 0402
R2119	1430778	Top	R	3	CHIPRES 0W06 10K J 0402
R2120	1825031	Bottom	C	4	VARISTOR ARRAY 2XVWM16V VC50 0405
R2200	1414605	Bottom	K	2	CHIPRES 0W25 0R22 J 0805
R2201	1430778	Bottom	J	7	CHIPRES 0W06 10K J 0402
R2202	1430770	Bottom	O	5	CHIPRES 0W06 4K7 J 0402
R2203	1430770	Bottom	O	5	CHIPRES 0W06 4K7 J 0402
R2204	1430804	Bottom	O	5	CHIPRES 0W06 100K J 0402
R2205	1430804	Bottom	O	6	CHIPRES 0W06 100K J 0402
R2206	1430804	Bottom	O	4	CHIPRES 0W06 100K J 0402
R2207	1430804	Bottom	O	4	CHIPRES 0W06 100K J 0402
R2400	1430778	Bottom	B	6	CHIPRES 0W06 10K J 0402
R2401	1430770	Bottom	F	2	CHIPRES 0W06 4K7 J 0402
R2402	1430770	Bottom	H	2	CHIPRES 0W06 4K7 J 0402
R2403	1430770	Bottom	H	2	CHIPRES 0W06 4K7 J 0402
R2404	1430798	Bottom	I	2	CHIPRES 0W06 56K J 0402
R2406	1430690	Bottom	H	2	CHIPRES JUMPER 0R0 0402
R2407	1430804	Bottom	I	2	CHIPRES 0W06 100K J 0402
R2408	1430812	Bottom	H	2	CHIPRES 0W06 220K J 0402
R2600	1413850	Bottom	D	9	CHIPRES 0W125 4R7 J 0805
R2700	4129071	Bottom	J	7	ASIP SIM INTERFACE ** PB-FREE **
R2800	1430770	Bottom	M	6	CHIPRES 0W06 4K7 J 0402
R2801	1430770	Bottom	M	7	CHIPRES 0W06 4K7 J 0402
R2802	1430117	Bottom	M	6	CHIPRES 0W06 100R F 200PPM 0402
R2803	1430117	Bottom	M	6	CHIPRES 0W06 100R F 200PPM 0402
R2804	1430784	Bottom	M	5	CHIPRES 0W06 15K J 0402
R2805	1430710	Bottom	M	5	CHIPRES 0W06 22R J 0402
R2806	1430778	Bottom	M	7	CHIPRES 0W06 10K J 0402
R2807	1430700	Bottom	M	7	CHIPRES 0W06 10R J 0402
R2808	1430778	Bottom	O	5	CHIPRES 0W06 10K J 0402
R2821	1430804	Bottom	C	2	CHIPRES 0W06 100K J 0402
R2900	1430770	Bottom	J	5	CHIPRES 0W06 4K7 J 0402

Item	Code	Side	X	Y	Description
R2901	1430754	Bottom	J	6	CHIPRES OW06 1K0 J 0402
R2902	1430770	Bottom	J	5	CHIPRES OW06 4K7 J 0402
R2903	1430754	Bottom	J	6	CHIPRES OW06 1K0 J 0402
R2904	1430770	Bottom	J	6	CHIPRES OW06 4K7 J 0402
R2905	1430770	Bottom	J	8	CHIPRES OW06 4K7 J 0402
R3000	1430722	Bottom	M	7	CHIPRES OW06 68R J 0402
R3001	1430804	Bottom	O	5	CHIPRES OW06 100K J 0402
R3002	1430770	Bottom	J	7	CHIPRES OW06 4K7 J 0402
R3200	1430690	Bottom	J	2	CHIPRES JUMPER OR0 0402
R3201	1430804	Bottom	I	2	CHIPRES OW06 100K J 0402
R3202	4129101	Bottom	K	2	ASIP MMC FILTER *** PB-FREE ***
R6000	1430830	Bottom	N	2	CHIPRES OW06 1M0 J 0402
R6001	1430778	Bottom	N	3	CHIPRES OW06 10K J 0402
R6002	1430778	Bottom	O	3	CHIPRES OW06 10K J 0402
R6003	1430832	Bottom	N	3	CHIPRES OW06 2K7 J 0402
R6005	1430691	Bottom	O	3	CHIPRES OW06 2R2 J 0402
R6007	1430690	Bottom	N	4	CHIPRES JUMPER OR0 0402
R6100	1430778	Bottom	L	8	CHIPRES OW06 10K J 0402
R6101	1430778	Bottom	L	9	CHIPRES OW06 10K J 0402
R6102	1430792	Bottom	L	8	CHIPRES OW06 33K J 0402
R6103	1430804	Bottom	L	9	CHIPRES OW06 100K J 0402
R6104	1430792	Bottom	K	8	CHIPRES OW06 33K J 0402
R6105	1430786	Bottom	J	9	CHIPRES OW06 18K J 0402
R7000	1430780	Bottom	I	7	CHIPRES OW06 12K J 0402
R7001	1430778	Bottom	I	9	CHIPRES OW06 10K J 0402
R7002	1430790	Bottom	I	9	CHIPRES OW06 27K J 0402
R7003	1430778	Bottom	J	4	CHIPRES OW06 10K J 0402
R7004	1430730	Bottom	I	8	CHIPRES OW06 150R J 0402
R7005	1430734	Bottom	I	8	CHIPRES OW06 220R J 0402
R7006	1430690	Bottom	I	7	CHIPRES JUMPER OR0 0402
R7007	1430794	Bottom	I	7	CHIPRES OW06 39K J 0402
R7008	1430794	Bottom	I	8	CHIPRES OW06 39K J 0402

Parts Lists and Exploded View

Item	Code	Side	X	Y	Description
R7100	1430754	Bottom	I	5	CHIPRES 0W06 1K0 J 0402
R7101	1430744	Bottom	I	4	CHIPRES 0W06 470R J 0402
R7102	1430770	Bottom	H	5	CHIPRES 0W06 4K7 J 0402
R7103	1430776	Bottom	I	3	CHIPRES 0W06 8K2 J 0402
R7104	1430790	Bottom	I	4	CHIPRES 0W06 27K J 0402
R7160	1430681	Bottom	D	3	CHIPRES 0W06 4R3 J 0402
R7161	1430796	Bottom	F	3	CHIPRES 0W06 47K J 0402
R7162	1430724	Bottom	F	3	CHIPRES 0W06 82R J 0402
R7163	1430796	Bottom	F	3	CHIPRES 0W06 47K J 0402
R7164	1430681	Bottom	E	3	CHIPRES 0W06 4R3 J 0402
R7165	1430796	Bottom	F	3	CHIPRES 0W06 47K J 0402
R7200	1430700	Bottom	G	6	CHIPRES 0W06 10R J 0402
R7203	1430690	Bottom	F	5	CHIPRES JUMPER 0R0 0402
R7204	1430726	Bottom	J	7	CHIPRES 0W06 100R J 0402
R7205	1430778	Bottom	G	5	CHIPRES 0W06 10K J 0402
R7208	1430700	Bottom	E	6	CHIPRES 0W06 10R J 0402
R7209	1430690	Bottom	F	6	CHIPRES JUMPER 0R0 0402
R7210	1430730	Bottom	G	6	CHIPRES 0W06 150R J 0402
R7211	1430778	Bottom	F	6	CHIPRES 0W06 10K J 0402
R7212	1430778	Bottom	F	6	CHIPRES 0W06 10K J 0402
R7213	1430766	Bottom	F	6	CHIPRES 0W06 3K9 J 0402
R7215	1430762	Bottom	I	3	CHIPRES 0W06 2K2 J 0402
R7216	1430700	Bottom	D	6	CHIPRES 0W06 10R J 0402
R7300	1430720	Top	C	8	CHIPRES 0W06 56R J 0402
R7301	1820039	Bottom	E	7	NTC RES 0W1 47K J B 4050+-3% 0402
R7302	1430720	Top	B	8	CHIPRES 0W06 56R J 0402
R7304	1430690	Top	B	7	CHIPRES JUMPER 0R0 0402
S2401	5409235	Bottom	B	7	SM TACT SW TRAV 0.2 4.1X3.55X1.75
S2402	5201001	Bottom	F	1	SM VOLUME BUTTON 16VDC 50MA
S2403	5201001	Bottom	H	1	SM VOLUME BUTTON 16VDC 50MA
T7000	4550271	Bottom	G	9	BALUN 900+/-100MHZ 0.9DB
T7001	4550273	Bottom	H	8	TRANSF BALUN 50:100 1900+/-100MHZ

Item	Code	Side	X	Y	Description
V2000	4113721	Bottom	P	2	TVS DI 1PMT16AT3 16V 175W PWRMITE
V2101	4210431	Top	B	3	TR BC848BL3 N 30V 0A1 0W25 TSLP-3
V2400	4210431	Bottom	I	2	TR BC848BL3 N 30V 0A1 0W25 TSLP-3
V2900	4210431	Bottom	J	8	TR BC848BL3 N 30V 0A1 0W25 TSLP-3
V6100	4110965	Bottom	L	8	CAP.DI BB202 CT 2.5 FM 0R8 SOD523
V6101	4110965	Bottom	L	9	CAP.DI BB202 CT 2.5 FM 0R8 SOD523
V7100	4110921	Bottom	H	4	CAP.DI BBY57-02W 1/4 16/4P SOD523
X2000	5460061	Bottom	Q	6	SM SYSTEM CONNECTOR 14POL
X2002	5409255	Bottom	D	7	SM LYNX BATT CONN 3POL 12V 2A H7.
X2100	5469271	Bottom	B	3	CONN AUD 3POL SMD 2.5MM DIA
X2450	5469279	Bottom	D	2	CONN BTB 2X30 F P0.4
X2700	5434003	Bottom	I	6	SM SIM CONN 2X3POL P2.54 H2.2
X3200	5406969	Bottom	L	2	SM MMC CONN 6POL P2.5 H1.6
X7071	5409293	Bottom	P	9	ANTENNA GROUND CLIP SMD DMD10149
X7300	5429065	Bottom	C	8	CONN RF+SW 100V 1W 50R 2.2GHZ
X8000	5409309	Top	A	2	MODULE ID COMPONENT 2.8X1.8X0.3
Z2101	4129269	Bottom	M	3	ASIP AUDIO OUTPUT STAGE
Z2102	4129269	Bottom	M	4	ASIP AUDIO OUTPUT STAGE
Z2103	4129267	Top	C	3	ASIP AUDIO MICROPHONE INPUT STAGE
Z2104	4129267	Top	R	6	ASIP AUDIO MICROPHONE INPUT STAGE
Z2105	4129267	Top	Q	8	ASIP AUDIO MICROPHONE INPUT STAGE
Z2106	4129269	Bottom	M	4	ASIP AUDIO OUTPUT STAGE
Z2400	4129031	Top	Q	5	ASIP KEYBOARD INTERFACE *PB-FREE*
Z6000	4551041	Bottom	O	2	LTCC FILT 2441.75+-41.75MHZ 2.5X2
Z7000	4511427	Bottom	G	9	SAW FILT 836.5+-12.5MHZ 2X1.6
Z7001	4513007	Bottom	G	8	BAW FILT 1880+-30MHZ 2X1.6X0.6
Z7160	4511441	Bottom	E	5	SAW FILT 881.5+-12.5MHZ/2.5 2X1.6
Z7161	4511423	Bottom	E	3	SAW FILT 1960+-30MHZ/3.2DB 2X1.6
Z7162	4510439	Bottom	F	4	XTAL FILT 128.1MHZ/4DB 3X3X1
Z7163	4511543	Bottom	G	3	SAW FILT 128.1MHZ 7X5X1.48

Parts Lists and Exploded View

Item	Code	Side	X	Y	Description
Z7300	4550295	Bottom	C	8	DIPL 859+/-35MHZ-1920+/-70MHZ
Z7301	4512197	Bottom	C	6	DUPL 1930-1990/1850-1910MHZ 5X5
Z7302	4512203	Bottom	C	7	DUPL 824-849/869-894MHZ 3.8X3.8X1.5